

MULTI-PURPOSE HEAVY DUTY

14', 16', 18'

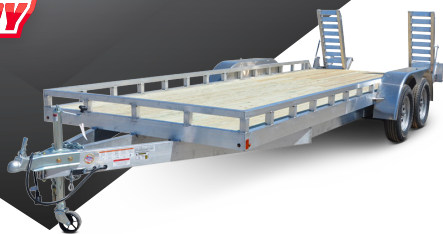

14', 16', 18'

STANDARD FEATURES

- > All Aluminum Construction
- > 16" O/C Floor Crossmembers
- > 2"x6" Subframe Tubing
- > 2-5/16" A-Frame Coupler
- > (2) 15000# Safety Chains
- > Dexter Torsion Ride Axles
- > 5000# Pedestal Jack
- > 5/4" Pressure Treated Decking
- > HD 2"x2" Perimeter Rub Rail
- > Adjustable HD Flip Up Ramps (16"x5')
- > Recessed LED Marker Lights
- > 4-Year Limited Warranty

STANDARD SPECIFICATIONS

TRAILER MODEL	6.5X14	6.5X16	6.5X18
Model Number	HPAT6.5x14	HPAT6.5x16	HPAT6.5x18
Deck (WxL)	80"x14'	80"x16'	80"x18'
Overall (WxL)	102"x18'	102"x20'	102"x22'
Deck Height	24"	24"	24"
Hitch Height	20"	20"	20"
Axle(s)-Qty/Rating	2-3500# Braked	2-3500# Braked	2-3500# Braked
Wheels	15" Silver Mod	15" Silver Mod	15" Silver Mod
Tires	205/75R15	205/75R15	205/75R15
GVWR	7000#	7000#	7000#
Curb Weight	1350#	1500#	1650#
Payload	5650#	5500#	5350#
Power Connection	7-Way Round	7-Way Round	7-Way Round

OPTIONS & ACCESSORIES

RAMP OPTIONS

Upgrade to 6' Car Hauler Grade Stowaway Ramps (Replaces HD Flip-Up Ramps)

FLOORING OPTIONS

Upgrade to Extruded Aluminum Decking

AXLE OPTIONS

Upgrade to 2-5K Torsion Braked Axles (From 2-3K Braked)

TIE-DOWN OPTIONS

5000# Recessed Heavy Duty D-Ring w/Backing Plate (Installed)

Zinc 6000# Recessed Swivel D-Ring w/Backing Plate (Installed)

TIRE/WHEEL ASSEMBLIES & ACCESSORIES

Upgrade to 15" Aluminum (Radial; From 15" Silver Mod Radial Wheels)

Spare 15" Silver Mod Wheel w/ 205/75R15 Tire

Spare 15" Aluminum Wheel w/ 205/75R15 Tire

Bolt-On Spare Tire Carrier (Tongue-Mounted)

ACCESSORIES

Large Diamond Plate Lockable Toolbox (Tongue-Mounted; Requires Wishbone Tongue)

Stabilizer Jacks (Installed; Pair)



RAMP CAPACITY BY MODEL

Ramp Type	Applicable Models	Capacity
Utility Trailer Rear Ramp (Fold-Down)	SSR (All Sizes), AR 2.0 (All Sizes), WR 2.0 (All Sizes), FA 2.0 (All Sizes), Landscape 2.0 (All Sizes)	750#
Utility Trailer Rear Ramp (Fold-Down Bi-Fold)	SSR (Optional, All Sizes), AR 2.0 (Optional, All Sizes), WR 2.0 (Optional, All Sizes), FA 2.0 (Optional, All Sizes), Landscape 2.0 (Optional, All Sizes)	750#
Deckover Equipment Trailer Ramps (Stow)	(All Sizes)	4000# (Pair)
Deckover Equipment Trailer Ramps 14K (Fold-Down)	(All Sizes)	5000# (Pair)
Patriot Ramps (Fold-Down)	Stowaway 6' Aluminum Ramps	4000# (Pair)
Patriot Ramps 14K (Fold-Down)	(All Sizes)	5000# (Pair)
Dump Trailers (Side-Stow, Optional)	(All Sizes)	4000# (Pair)
ATV (83" Wide, Side-Stow)	(All Sizes)	1200# (Pair)
ATV (88" Wide, Side-Stow)	(All Sizes)	750# (Pair)
Open Motorcycle (Rear-Stow)	(All Sizes)	1200#
Slingshot Rear Ramp (Fold-Down Bi-Fold)	HU-SLINGSHOT	1500#
Open Car Hauler 2.0 (Stow)	(All Sizes)	4000# (Pair)
Open Car Hauler 2.0-10K (Stow)	(All Sizes)	4000# (Pair)
Open Car Hauler Standard (Stow)	(All Sizes)	4000# (Pair)
Open Snow (Rear Stow)	HFS	750#
Sport Deck (Rear Stow, Telescoping)	HFS	1000#
Enclosed Cargo (4', 5', 6' Wide)	(All Sizes)	1500#
Enclosed Cargo (7', 7.5' Wide)	(All Sizes)	1500#
Enclosed Cargo (8.5' Wide, Premium)	(All Sizes)	1500#
Enclosed Motorcycle (7' Wide)	(All Sizes)	1500#
Enclosed Car Hauler (8.5' Wide)	(All Sizes)	4000#
Enclosed Gooseneck (8.5' Wide, Rear)	(All Sizes)	4000#
Enclosed Gooseneck (8.5' Wide, Side, Optional)	(All Sizes)	1200#
Enclosed Snowmobile (7', 7.5', 101" Wide, Rear)	(All Sizes)	1500#
Enclosed Snowmobile (7', 7.5', 101" Wide, Front)	(All Sizes)	1200#
Enclosed Snowmobile (Crossover, Rear)	(All Sizes)	1500#